



इकल
लुहारवा
BUILDERS & DEVELOPERS

SH

SHIVAM MANSION

Comfort & Luxury In Every Space

RERA:- RAJ/P/2023/2329



Welcome to

S

SHIVAM MANSION

Plot NO. D11, D12, D13, NANDAN VIHAR,
JAGATPURA, JAIPUR

Comfort & Luxury In Every Space

Are you looking for a dream home in the heart of Jaipur?

Look no further than

Shree Mahakaal Builders and Developers.

Established in 2000, this reputed real estate company has been providing quality homes to its customers ever since.

Shree Mahakaal Builders and Developers

Recently, introduced

a brand new project by the name of

'Shivam Mansion', prime location of Jagatpura, Jaipur. These projects offer 2 and 3 BHK apartments with all modern amenities like gymnasium, club house etc.

The apartments are designed to provide maximum comfort and convenience to its residents.





The company has a team of experienced professionals who strive hard to ensure that each project meets the highest standards of quality and safety. They use only top-notch materials for construction which ensures durability and longevity of the buildings. Moreover, they also take care of timely completion so that customers can move into their dream homes without any delay.

(102)3 BHK
SALABLE AREA 1578'.48" SQ.FT.
BUILTUP AREA 1127'.49" SQ.FT.
CARPET SQ.FT. 957.35" SQ. FT.

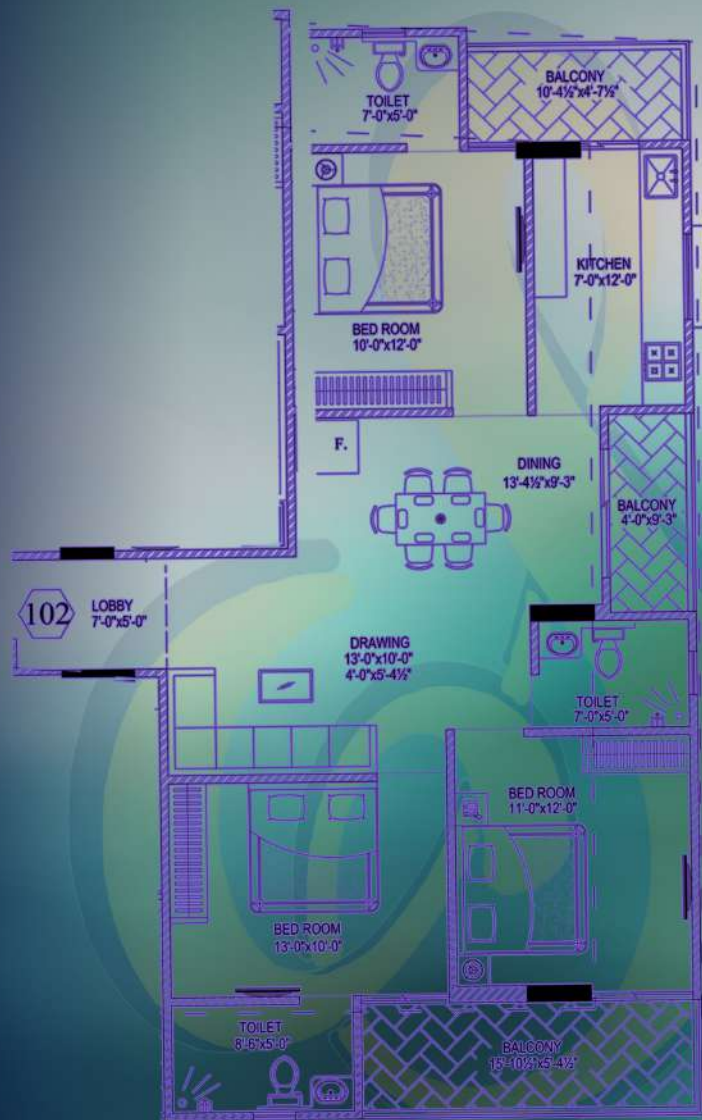

(103)3 BHK
SALABLE AREA 1472'.20" SQ.FT.
BUILTUP AREA 1051.57" SQ.Ft.
CARPET AREA 862'.73" SQ.FT.

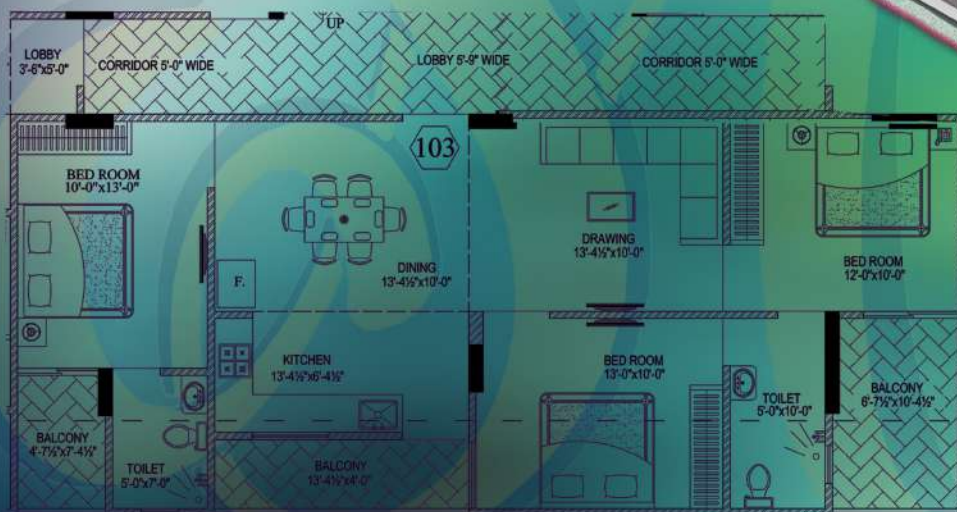

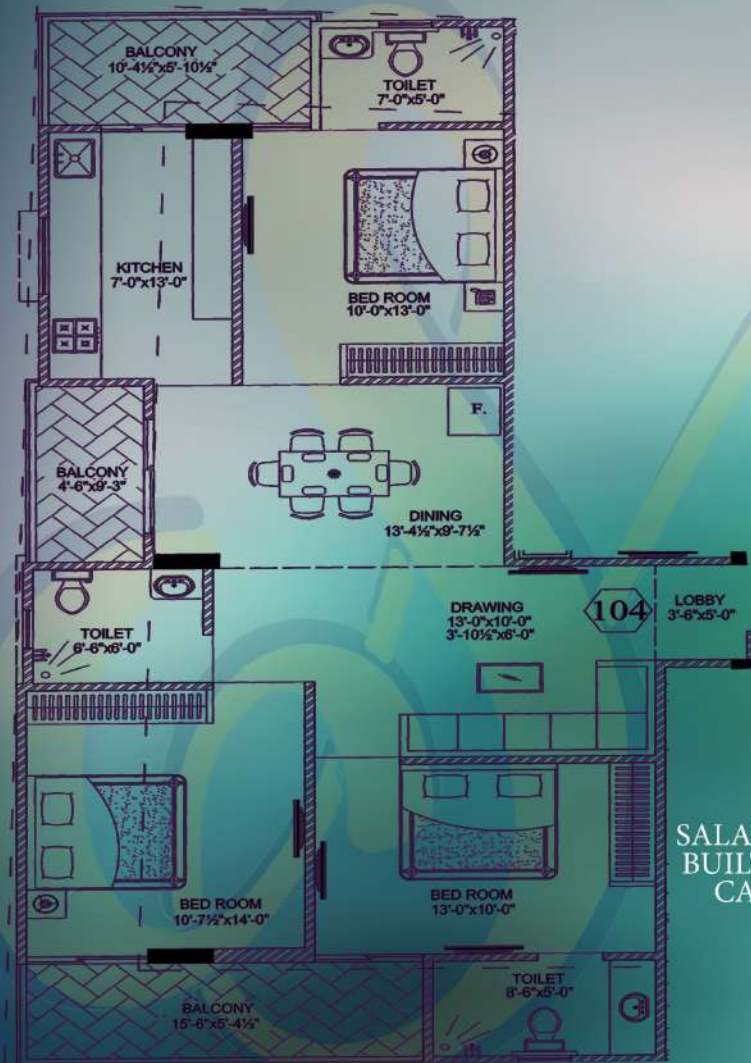

(104)3 BHK
 SALABLE AREA 1664.70" SQ.FT.
 BUILTUP AREA 1189.07" SQ.Ft.
 CARPET AREA 968' SQ.FT.





(105) 2 BHK
 SALABLE AREA 1053'.40" SQ.FT.
 BUILT UP AREA 752'.43" SQ.FT
 CARPET AREA 637'.87" SQ.FT..

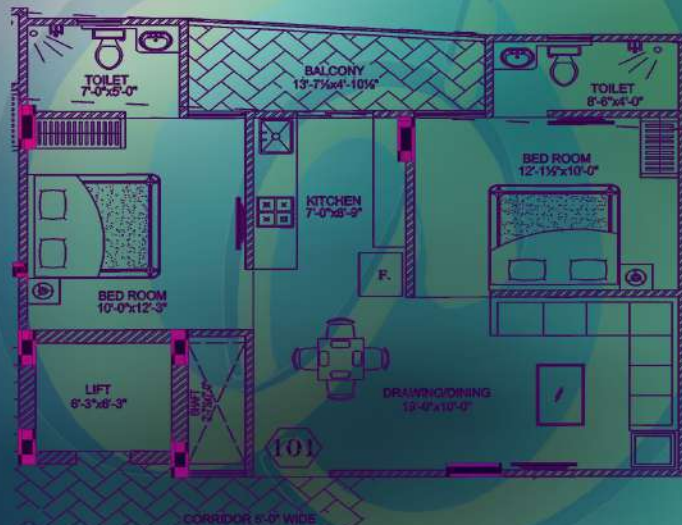

(101) 2 BHK
 SALABLE AREA 980'.80" SQ.FT.
 BUILT UP AREA 700'.57" SQ.FT
 CARPET AREA 609'.35" SQ.FT.



Location:

Shivam Mansion is located in one of Jaipur's most sought after localities - Jagatpura.

The area boasts excellent connectivity with leading schools, colleges, hospitals, malls etc. all within close proximity to the complex.

It has easy access to public transport systems such as buses and trains making it ideal for individuals looking for a comfortable living experience amidst urban lifestyle needs.

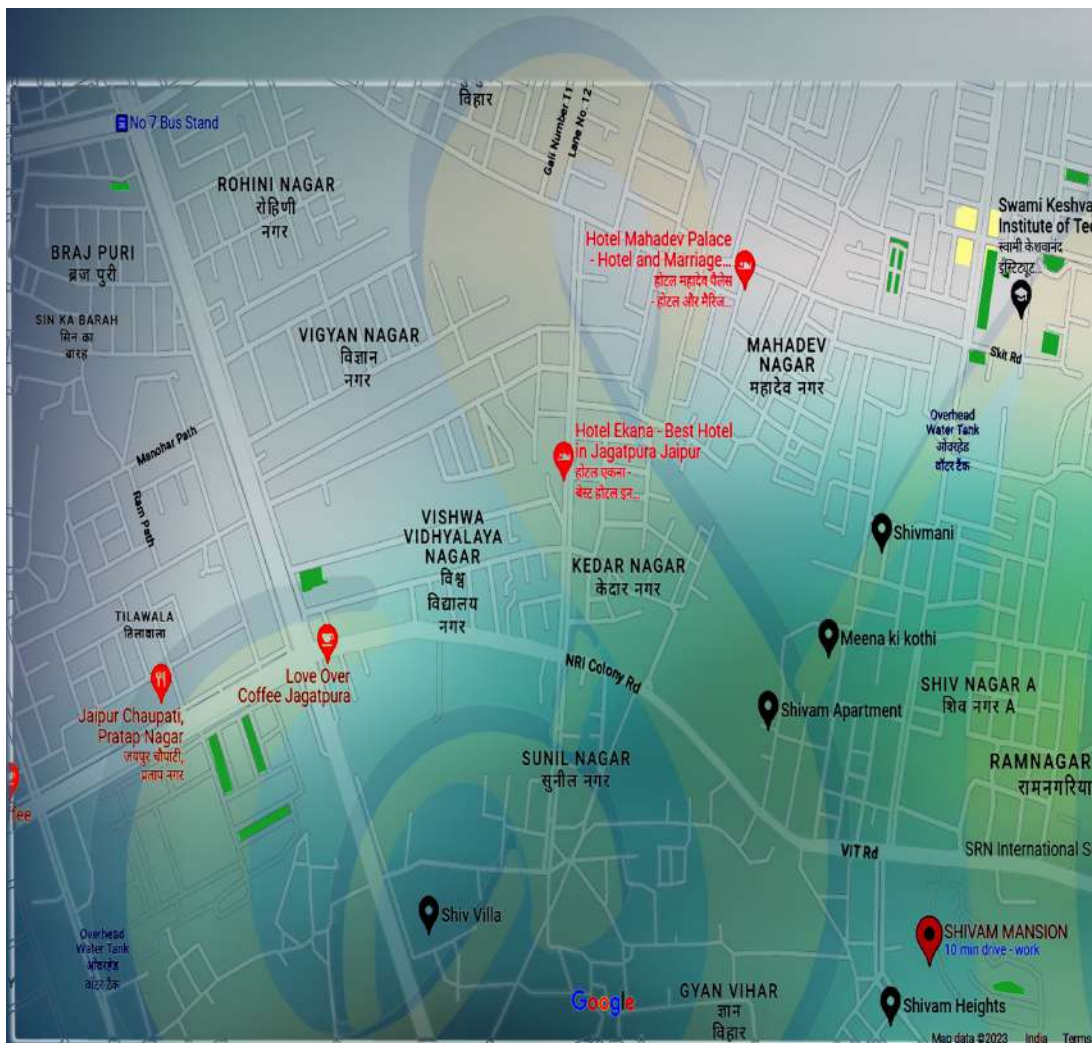

SHIVAM MANSION

Comfort & Luxury In Every Space



Scan For Location



Fiat Type	2bhk	3bhk	3bhk	3bhk	2bhk
Fiat No.	101	102	103	104	105
Built Up Area	=700.57 sq. ft.	=1127.49 sq. ft.	=1051.57 sq. ft.	=1189.07 sq. ft.	=752.43 sq. ft.
Super Built Up Area	=980.80 sq. ft.	=1578.48 sq. ft.	=1472.20 sq. ft.	=1664.70 sq. ft.	=1053.40 sq. ft.
Carpet Area	=609.35 sq. ft.	=957.35 sq. ft.	=862.73 sq. ft.	=968.00 sq. ft.	=637.87 sq. ft.

PROJECT:- PROPOSED RESIDENTIAL BUILDING AT PLOT NO. D-11, D-12, D-13 NANDAN VIHAR JAGATPURA JAIPUR

DRAWING:- TYPICAL FLOOR PLAN (1st to 6th)

SCALE :- N.T.S.

DRN. Digvijay Singh

APPD. Shri Krishan Sharma

ARCHITECT :-

SPACE GRID
C-48, Vidya Apartment parus Marg,
Bapu Nagar, near Janta Store Circle,
Jaipur-302015
Ph-0514618766, 0141-4095506 (a)
Email - info.spacegrid@gmail.com



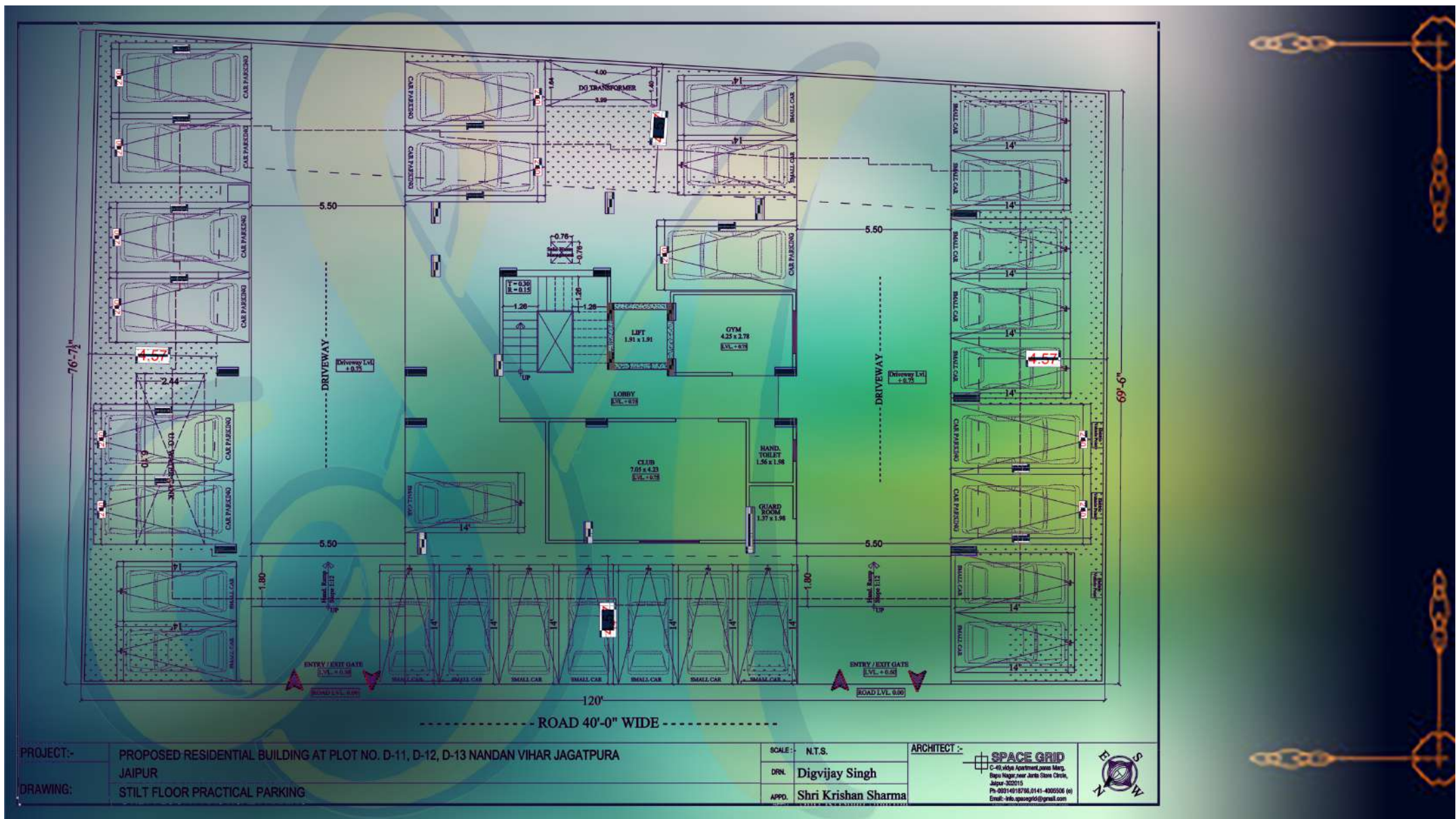

Specifications ...

STRUCTURE

- Earthquake resistant RCC framed structure
- Energy efficient & eco - friendly design

APARTMENTS

- Vitrified tiles flooring
- False ceiling in drawing
- POP finish on all walls & ceilings
- Premium quality distemper on walls & ceilings
- AC copper piping in drawing/dining and all bedrooms
- UPVC windows with three track system
- Premium quality designer laminated flush doors
- Designer fittings on doors and windows

KITCHENS

- Under counter semi modular cabinets
- Granite working counters
- Stainless steel sink
- 2' tiles dado above the counter
- Provision for geyser & RO

WASHROOMS

- Designer ceramic wall tiles
- Ceramic tiles flooring
- Premium quality sanitary ware
- Premium quality CP fittings
- Grid false ceiling
- Extended Wall mounted WC

ELECTRICAL

- Premium quality wires & cables
- Premium quality modular switches & accessories
- Telephone wiring
- DTH wiring in each room
- Provision for inverter

WATER SUPPLY

- 24 X 7 water supply through overhead tank
- Underground water tank for additional storage
- Rainwater harvesting system to recharge ground water level

COMMON AMENITIES

- 1 High speed elevators with auto rescue devices
- Well equipped clubhouse
- Gymnasium, multi-purpose hall.
- Power backup in common areas
- Main entrance gate with separate entry & exit driveways
- Granite flooring in corridors and staircases
- Designer entrance lobby
- Multi- dwelling unit (MDU) system for DTH connectivity

SECURITY SYSTEM

- Round the clock 3 tier security
- 24 X 7 CCTV surveillance system
- Access control system at main entrance
- Intercom/EPABX facility



